

modaLIGHT®

INSTALLATION

• ZENGA

1

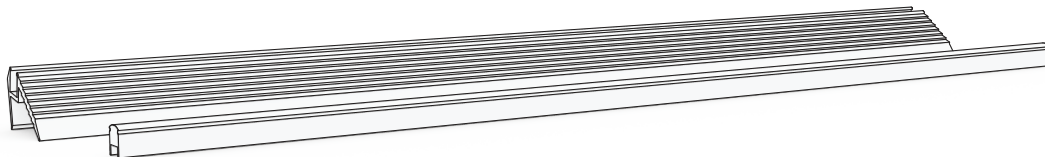

2

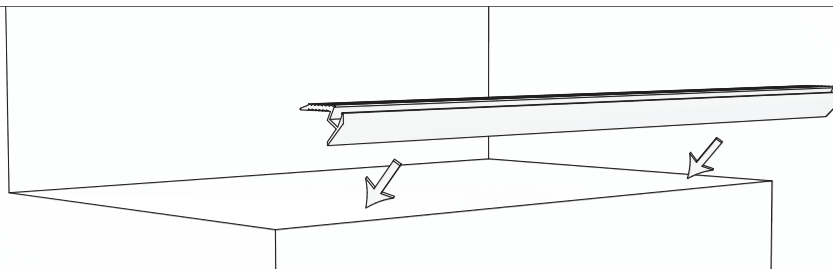

3

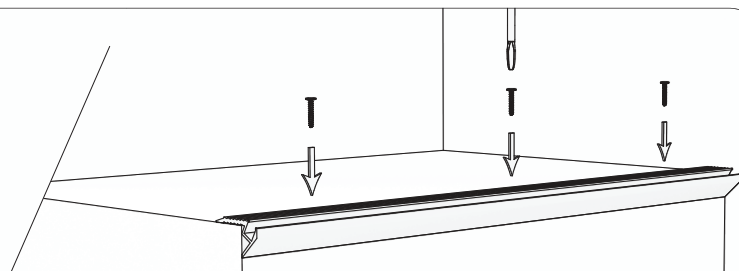
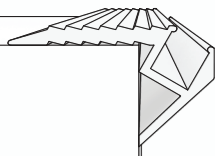

Ensure that ZENGA XTRUSION is squared off to corner before screwing into place

4

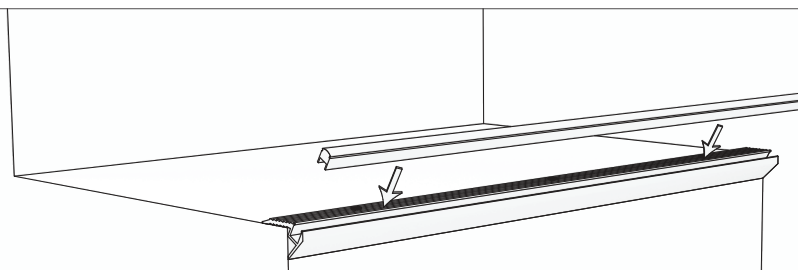

Snap diffuser into mounted ZENGA XTRUSION

All MODA LIGHT products should be installed by a Licensed Electrician to local & national code. Do not modify any MODA LIGHT components, plugs or accessories. Any modifications will void the warranty and may create a potential safety hazard. Do not put on the same circuit as inductive loads. Incorrect wiring will result in irreparable permanent damage to the LEDs and fixture. MODA LIGHT tests all products before shipping, and will not replace items that have been destroyed by incorrect wiring or handling. Ensure electrical circuit is switched off before wiring. See MODA LIGHT terms and conditions for product limited warranty.